

BRACO OPEN CLOSE SOLDERING TYPE COPPER RING TERMINALS

Braco Open Close Terminals are made out of EC grade copper. These terminals ensure completeness and ease of conductor entry so that contact is reliable and have more tensile strength. The terminals are annealed to avoid cracking or breaks and are tin plated to avoid oxidization and to achieve maximum corrosion protection.

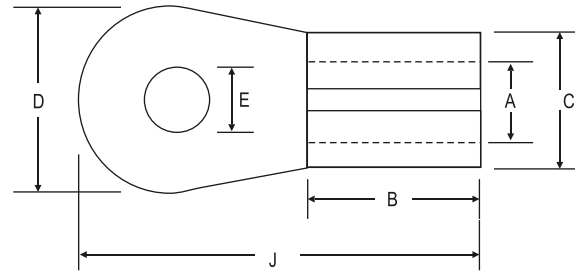

Material Copper BS : 1897
Finish : Electro Tinned

Size Sq. mm	Dimensions						Code No.
	E	A	C	D	B	J	
1.5	4.2	1.6	3.2	7	5	15	OC - 71
2.5	5.2	2.3	3.9	9	6	18	OC - 72
4	5.2	2.8	4.8	9	6	20	OC - 73
6	6.5	3.6	5.6	12	7	24	OC - 74
10	6.5	4.4	6.4	12	9	27	OC - 75
16	8.2	5.4	7.8	15	11	32	OC - 76
25	8.2	7.0	10.2	15	14	36	OC - 77
35	8.2	8.0	11.2	18	15	41	OC - 78
50	10.2	9.5	13.1	24	18	50	OC - 79
70	10.2	11.8	15.8	28	23	58	OC - 80
95	12.7	13.5	18.7	32	25	66	OC - 81
120	12.7	15.5	21.1	34	29	73	OC - 82
150	12.7	16.5	22.9	38	30	79	OC - 83
185	16.2	18.5	25.7	42	35	87	OC - 84
225	16.2	21.0	28.2	44	40	92	OC - 85
240	16.2	22.5	30.5	48	42	100	OC - 86
300	20.3	25.0	34.0	54	45	110	OC - 87
400	20.3	29.5	39.5	62	54	125	OC - 88
500	20.3	32.0	42.8	62	58	137	OC - 89
625	20.3	36.0	46.8	70	65	148	OC - 90

